

# REPLACEMENT PARTS SUITABLE FOR SAF®

## CP40R, CP100R

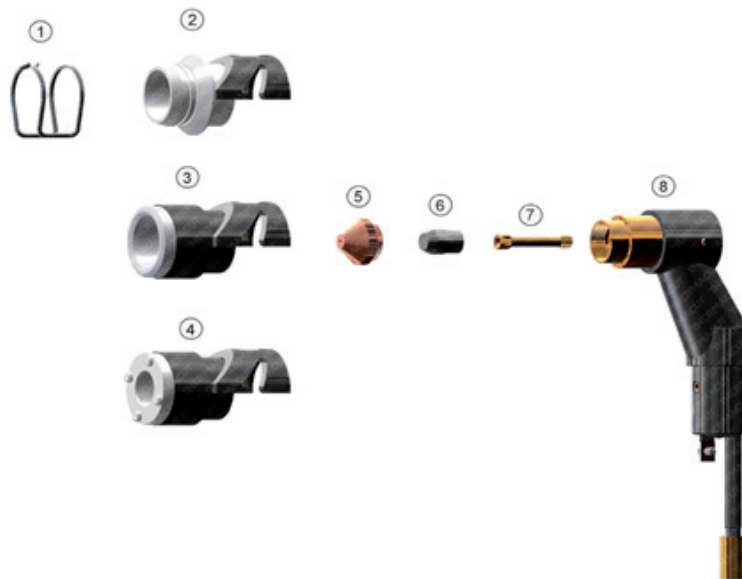

Item	Part No.	Ref. No.	Description	Std. Pkg.	Item	Part No.	Ref. No.	Description	Std. Pkg.
1.	T-0431	0408-2053	Guide Wire (=W000302609)	5	6.	T-3565	0408-2534	Electrode Hf (=0408-2404, 095482)	5
2.	T-0430	0408-2270	Shroud (=0408-2267, W000302606)	1		T-3549	0408-2051	Electrode, Zr (=W000302545)	5
3.	T-8307	0408-2268	Shroud (=W000302552)	1	7.	T-8067	0408-2381	Plunger Tube (=W000302554)	1
4.	T-8306	0408-2405	Shroud (=W000302557)	1	8.	T-1829	0408-2056	Torch Body, Hand CP40R (=W000142824)	1
5.	T-8069	0408-2400	Tip 1.0mm(=0408-2261)	5	NS	KT-1376	K.CP40R.CP100R.6M.K	CP40R®, CP100R® Cable Leads 6m (20')	1
NS	T-8070	0408-2401	Tip 1.2mm (=0408-2262)	5	NS	KT-1062	0408-2050	CP40R® Torch with Leads 6m (20')	1
NS	T-8071	0408-2396	Tip 1.6mm (=0408-2385)	5	NS	KT-1063	0408-2375	CP100R® Torch with Leads 6m (20')	1

## CPM-200, CPM-250, CPM-300, CPM-720

Item	Part No.	Ref. No.	Description	Std. Pkg.	Item	Part No.	Ref. No.	Description	Std. Pkg.
	T-11045	0408-1482	Electrode 90-120A	1		T-8753	0409-1279	Nozzle 180A, O <sub>2</sub>	1
	T-10022	0408-1283	O-Ring D8x1,25 Nitrile	1		T-8846	0409-1280	Nozzle 240A, O <sub>2</sub>	1
	T-8755	0409-2095	Electrode H25 120-240A	1		TN-0026	0409-1350	Nozzle 320A, N <sub>2</sub>	1
	T-8754	0409-2076	Nozzle 120A, O <sub>2</sub>	1		T-8848	0409-1351	Nozzle 500A, N <sub>2</sub>	1
	T-10136	0409-1278	Nozzle 150A, O <sub>2</sub>	1					

NS NOT SHOWN IN THE PICTURE